



SHINGARE<sup>TM</sup>  
INDUSTRIES PVT LTD

## CONTENTS

Sr. No.	Product	Page
1	Introduction	3
2	Square Drive Hydraulic Torque Wrench	6
3	Low Profile (Open/Ring) Type Hydraulic Torque Wrench	7
4	Reducers / Inserts	8
5	Heavy Duty Impact Sockets (STD/Deep)	9
6	Heavy Duty Reducers / Inserts	10
7	Low Profile (Open/Ring) Type Hydraulic Torque Wrench	12
8	Electric Power Pack	14
9	Pneumatic Power Pack	15
10	Hydraulic Bolt Tensioner	16
11	Top Side Bolt Tensioner	17
12	Multistage Bolt Tensioner	18
13	Bolt Tensioner Hand Pump	19
14	Bolt Tensioner Electric Pump	20
15	Bolt Tensioner Pneumatic Pump	21
16	Hydrotest Pump	22
17	Chart Recorder	24
18	Pneumatic Torque Wrench	25
19	Square Drive Electric Torque Wrench	28
20	HEX Drive Electric Torque Wrench	30
21	Electric Shear Wrench	32
22	Battery Torque Wrench	33
23	Torque Chart	34
24	Other Product Range	35



Education is necessary but not a pre-requisite for success in life. **Bhartiya Industries** is the best example of this theory. **Mr. Suryakant Shingare (HARIBHAI)**, the founder of the company is a non-matriculate technocrat with more than 10 years experience in flexible shaft manufacturing. He founded this company in 1989.

#### Basic Products:

Engineering products is our forte. We manufacture engineering products such as tube expander, tube cleaner, tube tools, hydraulic tube expansion, tube pulling, and pipe beveling machines. We also deal in manufacture of flexible shaft grinders, construction equipment, hydraulic torque wrench, impact socket, pneumatic tapping machines, and many more...

#### Brief History of the Company:

We were a small industry until 2003 engaged in production and supply of different types of flexible shafts for tube cleaning, brushes, flexible shaft grinder, and concrete vibrators. The year 2003 was a watershed year for the company.



**Mr. Pradip Shingare**, son of **Mr. Hari Shingare**, graduated from Mumbai University with a degree in Mechanical Engineering. He had great plans to take the company forward on the route to expansion. He ventured into export of the engineering products. By 2008, the company acquired the reputation as the largest exporter of tube cleaning machines and flexible shafts in India.

The year 2009 saw the expansion of the company into manufacture of products such as Tube expander, tube tools, and tube pulling machines. The company witnessed a record double-digit growth in this product range. In 2011, the company started developing a product range of pipe beveling machines. These machines are extremely popular in India as well as in the overseas market. The year 2013 witnessed the company foray into imports of different types of tools such as tapping tools, grinding tools, etc making us the leading player in India in these categories.

The year 2015 saw us entering into the sugar industry component with the manufacture of the Heavy Duty Sugar Dust Collector machine, Flex Repair 40 machine.

In 2016, we added **SHINGARE INDUSTRIES PVT. LTD.** a new company in our group. We were awarded ISO 9001:2015 certification for strictly followed quality norms and processes.

In 2021, amidst the global challenges posed by the pandemic, when many companies were forced to lay off employees, SIPL took a bold step by venturing into the new vertical of Pipe Cold Cutting & Beveling Machine, Bolt Torquing/Tensioning Services and the manufacturing of Hydraulic Torque Wrenches, Bolt Tensioners, and allied products. With a forward-thinking strategy and a dedicated team, SIPL quickly gained recognition as a trusted leader in the industry. Within just three years, the company became a prominent name in Bolt Torquing services across various sectors, including Rail/Metro, PEB structures, Power Plant and Oil & Gas shutdowns in India. SIPL's commitment to excellence and innovation has solidified its position as a top service provider in these critical industries.

#### Dedicated Staff:

We have a dedicated team of more than 70 people, many of whom are with us since the early days of the company. We have an excellent blend of youth, knowledge, and experience in our ranks.

#### Export oriented:

We export over 60% of our products to more than 65 countries all over the globe.

#### Expansion:

We feel the need to expand our business to enable us to serve the people of this country better. With this aim in mind, we established a new company in the name of SHINGARE INDUSTRIES PVT. LTD.

**Our main motto of business is "Growth with Trust."**

Our mission is to innovate and create an import substitute products in India.

---

We intend to build  
**Partnerships**  
that Scale  
**Global Platforms.**

---

We believe in partnerships.  
We believe in a successful collaboration that adds value to our businesses.  
We believe in win-win.

## Presence Across MENA & West Africa Region





# Hydraulic Torque Wrenches



# Square Drive Hydraulic Torque Wrench

**BHARTIYA**

**TUBE TOOLS**

## SSD SERIES

- The materials used are aluminum-titanium alloy and high-strength steel for greater strength, toughness, and durability.
- The precise design ensures accurate performance with a  $\pm 3\%$  margin.
- Anti-backlash mechanism prevents the wrench from turning backward.
- After tightening, the release lever lets you quickly remove the tool.
- The optimized design makes the tool compact and light. Swivel mechanism with  $360^\circ \times 180^\circ$  movement.
- The specified coating on the cylinder housing improves wear resistance.
- The high hardness of alloy steel reduces wear between the ratchet and pawl, increasing the tool's lifespan.
- Quick-connect coupler with leak-proof design.
- Newly developed piston seal material ensures an extended life cycle.

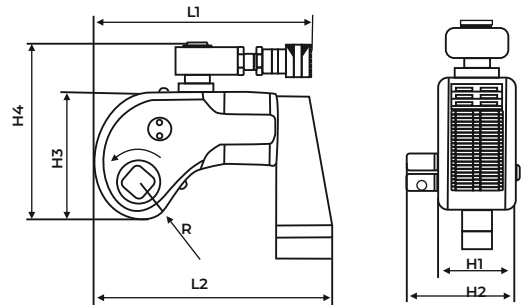

## SELECTION CHART

Model No.	Torque Range	Square Drive	Weight	L1	L2	H1	H2	H3	H3	H3
Units	N-m Ft-Lbs	Inch.	Kg	mm	mm	mm	mm	mm	mm	mm
SSD-1A	172-1727 126-1273	¾"	2	129	167	51	73	90	131	25
SSD-3A	452-4529 333-3340	1"	4.6	167	218	68	98	121	170	34
SSD-8A	1006-10064 741-7422	1-½"	10	223	293	92	135	163	211	46
SSD-10A	1497-14974 1104-11044	1-½"	14.8	264	323	100	141	177	225	50
SSD-25A	3699-36992 2728-27283	2-½"	32.5	329	432	104	104	240	288	65
SSD-35A	4866-48666 3588-35894	2-½"	50	327.5	496.5	216	216	282	332	243.5

## ACCESSORIES

For Special Reaction Arm, consult to SIPL!

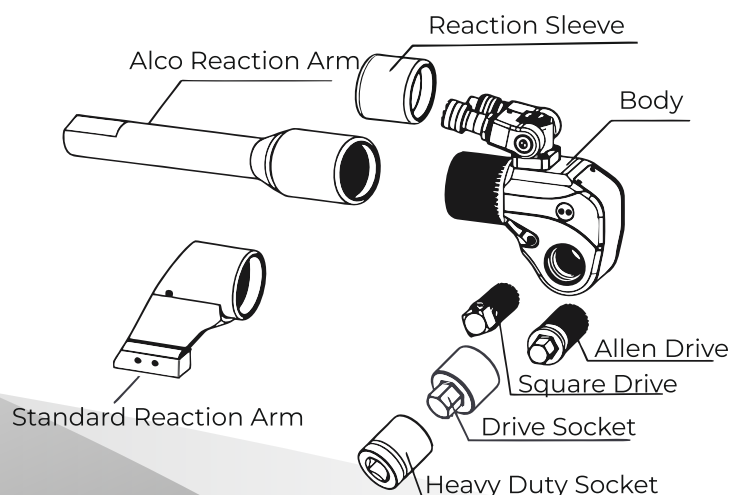

# Low Profile Hydraulic Torque Wrenches

## SXD SERIES

- Made from Aluminium-Titanium and high-strength alloy steel for better strength and durability.
- Provides accurate performance ( $\pm 3\%$ ) in tight spaces.
- Anti-backlash mechanism prevents the wrench from turning backward.
- Swivel mechanism with  $360^\circ \times 180^\circ$  movement.
- A wide range of hex sizes available for various applications.
- Special coating on the aluminum power head improves wear resistance.
- High hardness alloy steel reduces wear between the ratchet and pawl, extending tool life.
- Quick-connect coupler with leak-proof design.
- Newly developed piston seal material ensures an extended life cycle..

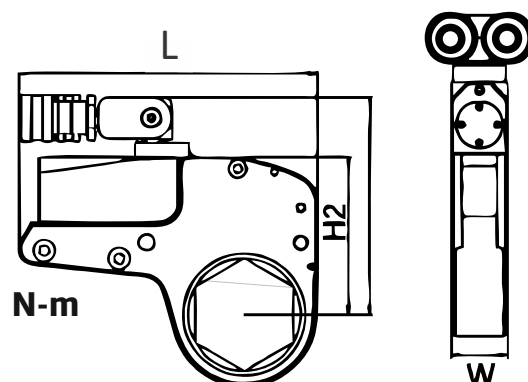

## SELECTION CHART

Model No.	Torque Range	Links (A/F)	Power Head	Link Weight	L1	H1	H2	W
Units	N-m	mm	Kg	Kg	mm	mm	mm	mm
	Ft-Lbs	Inch						
SXD-2A	230-2302	19-60	1	1.53	186	135	98	32
	169-1697	$\frac{3}{4}$ " - $2\frac{3}{8}$ "						
SXD-4A	417-4170	34-80	2.3	4.53	246.1	186	136	43
	307-3075	$1\frac{5}{16}$ " - $1\frac{1}{8}$ "						
SXD-8A	1100-11100	41-105	4.1	7	297	214.9	165.1	53
	811-8186	$1\frac{5}{8}$ " - $4\frac{1}{8}$ "						
SXD-14A	1824-18243	50-117	7.05	12.6	361	239	189	64
	1345-13455	2" - $4\frac{1}{2}$ "						
SXD-32A	4400-44000	110-175	14.03	22.51	430	315	285	85
	3245-32452	$4\frac{1}{4}$ " - $6\frac{7}{8}$ "						

## SXD SERIES HEX / RATCHET LINKS

### REDUCERS

Reducer work together with the **SXD** Ratchet link.  
One single Ratchet link is suitable for many bolts sizes.

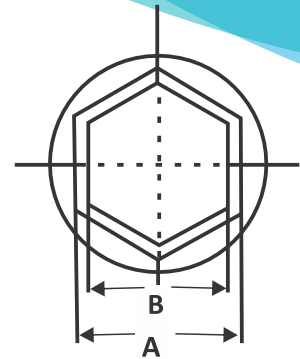
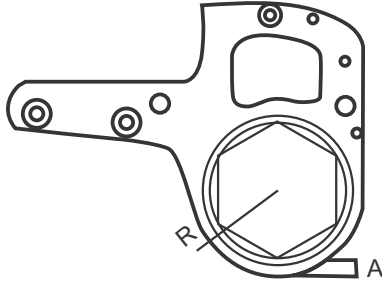

### SPECIFICATION

SXD-2A				SXD-4A				SXD-8A				SXD-14A				SXD-32A			
Type	R	A	Max Torque	Type	R	A	Max Torque	Type	R	A	Max Torque	Type	R	A	Max Torque	Type	R	A	Max Torque
SXD-2A-19	26	10	1890	SXD-4A-34	36	16	3040	SXD-8A-41	46	16	4822	SXD-14A-50	60	19	11980	SXD-32A-85	77	26	32890
SXD-2A-22	26	10	1890	SXD-4A-36	42	15	3040	SXD-8A-46	46	16	4822	SXD-14A-55	60	19	11980	SXD-32A-90	83	28	44000
SXD-2A-27	26	10	2110	SXD-4A-41	42	12	3040	SXD-8A-50	56	18	7200	SXD-14A-60	60	25	18244	SXD-32A-95	83	30	44000
SXD-2A-30	32	12	2110	SXD-4A-46	42	12	4280	SXD-8A-55	56	18	7200	SXD-14A-65	68	25	15020	SXD-32A100	83	30	44000
SXD-2A-32	32	12	2110	SXD-4A-50	50	14	4280	SXD-8A-60	56	18	7200	SXD-14A-70	68	25	15020	SXD-32A-105	96	30	44000
SXD-2A-34	32	12	2110	SXD-4A-55	50	14	4280	SXD-8A-65	68	20	9100	SXD-14A-75	68	25	15020	SXD-32A-110	96	30	44000
SXD-2A-36	38	14	2302	SXD-4A-60	50	14	5654	SXD-8A-70	68	20	9100	SXD-14A-80	68	25	15020	SXD-32A-115	96	30	44000
SXD-2A-41	38	14	2302	SXD-4A-65	61	16	5654	SXD-8A-75	68	20	9100	SXD-14A-85	76	28	18244	SXD-32A-117	96	30	44000
SXD-2A-46	38	14	2302	SXD-4A-70	61	16	5654	SXD-8A-80	68	20	9100	SXD-14A-90	76	28	18244	SXD-32A-120	96	30	44000
SXD-2A-50	46	16	2302	SXD-4A-75	61	16	5654	SXD-8A-85	78	22	11063	SXD-14A-95	76	30	18244	SXD-32A-125	128	30	44000
SXD-2A-55	46	16	2302	SXD-4A-80	61	16	5654	SXD-8A-90	78	22	11063	SXD-14A-100	76	30	18244	SXD-32A-130	128	30	44000
SXD-2A-60	46	16	2302	-	-	-	-	SXD-8A-95	78	22	11063	SXD-14A-105	87	30	18244	SXD-32A-135	128	30	44000
-	-	-	-	-	-	-	-	SXD-8A-100	78	22	11063	SXD-14A-110	87	30	18244	SXD-32A-140	128	30	44000
-	-	-	-	-	-	-	-	SXD-8A-105	78	22	11063	SXD-14A-115	87	30	18244	SXD-32A-145	128	30	44000
-	-	-	-	-	-	-	-	-	-	-	-	SXD-14A-117	87	30	18244	SXD-32A-150	128	30	44000
-	-	-	-	-	-	-	-	-	-	-	-	-	-	-	-	SXD-32A-155	128	30	44000
-	-	-	-	-	-	-	-	-	-	-	-	-	-	-	-	SXD-32A-160	128	30	44000
-	-	-	-	-	-	-	-	-	-	-	-	-	-	-	-	SXD-32A-165	128	30	44000
-	-	-	-	-	-	-	-	-	-	-	-	-	-	-	-	SXD-32A-170	128	30	44000
-	-	-	-	-	-	-	-	-	-	-	-	-	-	-	-	SXD-32A-175	128	30	44000

### ACCESSORIES

C Type Reaction	
Extending Reaction Arm	

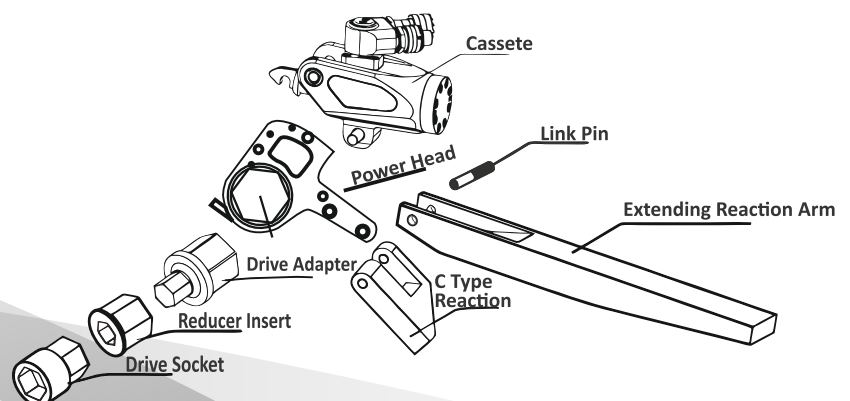

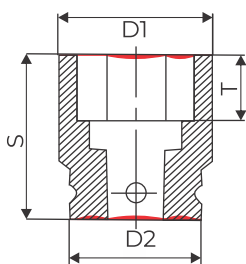

**6 POINTS  
IMPACT SOCKETS**

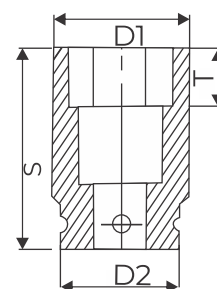

Model No.	Square Drive	Nut A/F		D1	D2	S	T	L
		inch	mm					
S-12M24	3/4"	-	24	40	44	46	21	90
S-12M27	3/4"	-		41	44	48	23	90
S-1217	3/4"	1.1/16	-	41	44	48	23	90
S-1230	3/4"	-	30	44	44	52	24	90
S-1220	3/4"	1.1/4	-	49	44	52	24	90
S-12M32	3/4"	-	32	49	44	52	26	90
S-12M36	3/4"	-	36	52	44	55	28	90
S-1223	3/4"	1.7/16	-	52	44	56	28	90
S-12M41	3/4"	-	41	57	44	59	36	90
S-1226	3/4"	1.5/8	-	57	44	59	36	90
S-12M46	3/4"	-	46	67	44	64	37	90
S-1229	3/4"	1.13/16	-	67	44	64	36	90
S-12M50	3/4"	-	50	70	54	67	39	90
S-1232	3/4"	2	-	73	54	67	39	90
12M55DH	3/4"	-	55	78	54	71	41	94
S-1635	3/4"	2.3/16	-	78	54	71	41	94
12M60DH	3/4"	-	60	82	52	75	45	98
S-1638	3/4"	2.3/8	-	82	54	75	45	98
S-12M24	1"	-	24	42	54	55	21	100
S-12M27	1"	-	27	46	54	55	23	100
S-1217	1"	1.1/16	-	46	54	55	23	100
S-12M30	1"	-	30	50	54	57	24	100
S-1220	1"	1.1/4	-	51	54	57	24	100
S-12M32	1"	-	32	51	54	57	26	100
S-12M36	1"	-	36	54	54	60	28	100
S-1223	1"	1.7/16	-	54	54	60	28	100
S-12M41	1"	-	41	63	54	64	36	100
S-1226	1"	1.5/8	-	63	54	64	36	100
S-12M46	1"	-	46	70	54	69	36	100
S-1229	1"	1.13/16	-	70	54	69	36	100
S-1250	1"	-	50	73	54	72	36	100
S-1232	1"	2	-	73	54	72	39	100
12M55DH	1"	-	55	82	54	76	41	105
S-1635	1"	2.3/16	-	82	54	80	41	105
12M60DH	1"	-	60	86	54	82	45	112
S-1638	1"	2.3/8	-	88	54	85	45	112
S-16M65	1"	-	65	92	54	85	46	118
S-1641	1"	2.9/16	-	92	54	85	46	118
S-16M70	1"	-	70	96	54	88	50	124
S-1644	1"	2.3/4	-	96	54	88	50	124
S-16M75	1"	-	75	100	86	92	57	124
S-1647	1"	2.15/16	-	100	86	92	57	124
S-16M100	1"	-	100	135	86	112	62	143
S-1650	1"	3.1/8"	-	105	86	97	57	132
S-16M80	1"	-	80	105	86	97	62	132
S-16M85	1"	-	85	115	86	100	62	132
S-1656	1"	3.1/2"	-	121	86	104	62	140
S-16M90	1"	-	90	127	86	104	62	140
S-16M95	1"	-	95	135	86	106	62	140

Model No.	Square Drive	Nut A/F		D1	D2	S	T	L
		inch	mm					
S-1662	1.1/2"	-	36	64	86	80	62	130
S-16M36	1.1/2"	-	41	69	86	83	28	130
S-16M41	1.1/2"	-	46	76	86	86	32	130
S-16M46	1.1/2"	1.13/16	-	76	86	86	36	130
S-1629	1.1/2"	-	50	81	86	90	36	130
S-12M50	1.1/2"	2	-	81	86	90	39	130
S-1232	1.1/2"	-	55	88	86	95	39	140
12M55DH	1.1/2"	2.3/16	-	88	86	95	41	140
S-1635	1.1/2"	-	60	96	86	98	41	140
S-16M60	1.1/2"	2.3/8	-	96	86	98	45	140
S-1638	1.1/2"	-	65	102	86	102	45	140
S-16M65	1.1/2"	2.9/16	-	102	86	102	46	140
S-1641	1.1/2"	-	70	108	86	102	46	150
S-16M70	1.1/2"	2.3/4	-	108	86	102	50	150
S-1644	1.1/2"	-	75	116	86	108	50	150
S-16M75	1.1/2"	2.15/16	-	116	86	108	57	150
S-1647	1.1/2"	-	80	120	86	110	57	150
S-16M80	1.1/2"	3.1/8	-	120	86	110	62	150
S-1650	1.1/2"	-	85	130	86	115	62	170
S-16M85	1.1/2"	-	90	135	125	118	62	170
S-16M90	1.1/2"	3.1/2	-	135	125	118	65	170
S-1656	1.1/2"	-	95	140	125	123	65	170
S-16M95	1.1/2"	-	100	148	125	128	70	190
S-16M100	1.1/2"	3.7/8	-	148	125	128	75	190
S-1662	1.1/2"	-	105	155	125	133	75	190
S-16M105	1.1/2"	4.1/4	-	155	125	133	80	190
S-1668	1.1/2"	-	110	161	150	138	80	200
S-16M110	1.1/2"	-	115	161	150	143	85	200
S-16M115	1.1/2"	4.5/8	-	175	150	149	94	200
S-1670	2.1/2"	-	80	135	125	140	94	190
S-16M80	2.1/2"	3.1/8	-	135	125	140	62	190
S-1650	2.1/2"	-	85	140	125	140	62	190
16M85DH	2.1/2"	-	90	145	125	140	62	190
16M90DH	2.1/2"	-	95	155	125	150	65	190
16M95DH	2.1/2"	3.7/8	-	155	125	150	70	190
1662DH	2.1/2"	-	100	160	125	150	70	200
S-24M100	2.1/2"	-	105	165	125	160	75	200
S-24M105	2.1/2"	-	110	174	150	160	80	210
S-24M110	2.1/2"	-	115	180	150	170	85	210
S-24M115	2.1/2"	4.1/2	-	180	150	170	90	210
S-2472	2.1/2"	5	-	195	150	175	90	220
S-2480	2.1/2"	-	130	195	150	175	98	220
S-24M130	2.1/2"	5.3/8	-	205	150	180	98	220
S-2482	2.1/2"	-	145	220	150	180	102	230
S-40M145	2.1/2"	5.3/4	-	220	150	180	105	230
S-4092	2.1/2"	6.1/8	-	230	180	190	105	250
S-4098	2.1/2"	6.1/2	-	240	180	200	110	-
S-40104	2.1/2"	6.7/8	-	255	180	200	120	-
S-40110	1"	3.7/8"	-	135	86	112	120	143



## HEAVY DUTY REDUCERS

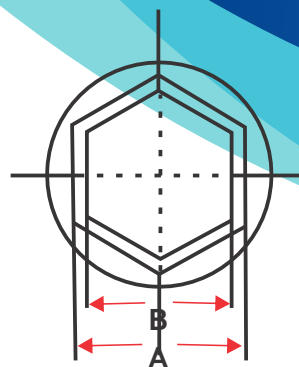

Nut Size (S)	Locking ring / Reducer		
		50/36	50/32
46	46/36	46/32	46/30
41	41/32	41/30	41/27
36	36/30	36/27	
32	32/27		
30			
27			
65	65/55	65/50	65/46
60	60/50	60/46	60/41
55	55/46	55/41	55/36
50	50/41	50/36	50/32
46	46/36	46/32	46/30
41	41/32	41/30	41/27
36	36/30	3/27	
32	32/27		
30			
27			
90	90/80	90/75	90/70
85	85/75	85/70	85/65
80	80/70	80/65	80/60
75	75/65	75/60	75/55
70	70/60	70/55	70/50
65	65/55	65/50	65/45
60	60/50	60/46	
55	55/46	55/41	
50			
115	115/105	115/100	115/95
110	110/100	110/95	110/90
105	105/95	105/90	105/85
100	100/90	100/85	100/80
95	95/85	95/80	95/75
90	90/80	90/75	90/70
85	85/75	85/70	85/65
80	80/70	80/65	
75	75/65		
70			
65			
155	155/145	155/130	155/120
145	145/130	145/120	145/115
130	130/120	130/115	130/110
120	120/110	120/105	120/100
115	115/105	115/100	115/95
110	110/100	110/95	110/90
105	105/95	105/90	100/80
100	100/90	100/85	100/80
95	95/85	95/80	
90	90/80		
85			
80			

## SXD SERIES HEX / RATCHET LINKS

### REDUCERS

Reducer work together with the SXD Ratchet link.

One single Ratchet link is suitable for many bolts sizes.

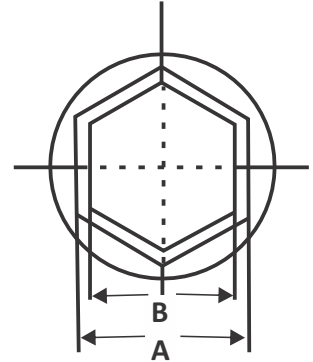
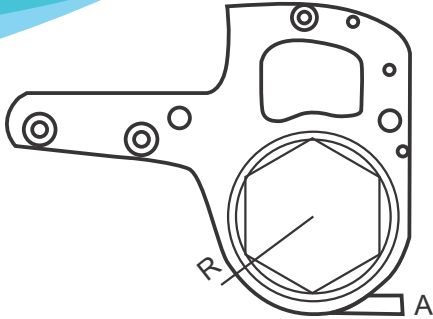

### SPECIFICATION

SXD-2A				SXD-4A				SXD-8A				SXD-14A				SXD-32A			
Type	R	A	Max Torque	Type	R	A	Max Torque	Type	R	A	Max Torque	Type	R	A	Max Torque	Type	R	A	Max Torque
SXD-2A-19	26	10	1890	SXD-4A-34	36	16	3040	SXD-8A-41	46	16	4822	SXD-14A-50	60	19	11980	SXD-32A-85	77	26	32890
SXD-2A-22	26	10	1890	SXD-4A-36	42	15	3040	SXD-8A-46	46	16	4822	SXD-14A-55	60	19	11980	SXD-32A-90	83	28	44000
SXD-2A-27	26	10	2110	SXD-4A-41	42	12	3040	SXD-8A-50	56	18	7200	SXD-14A-60	60	25	18244	SXD-32A-95	83	30	44000
SXD-2A-30	32	12	2110	SXD-4A-46	42	12	4280	SXD-8A-55	56	18	7200	SXD-14A-65	68	25	15020	SXD-32A100	83	30	44000
SXD-2A-32	32	12	2110	SXD-4A-50	50	14	4280	SXD-8A-60	56	18	7200	SXD-14A-70	68	25	15020	SXD-32A-105	96	30	44000
SXD-2A-34	32	12	2110	SXD-4A-55	50	14	4280	SXD-8A-65	68	20	9100	SXD-14A-75	68	25	15020	SXD-32A-110	96	30	44000
SXD-2A-36	38	14	2302	SXD-4A-60	50	14	5654	SXD-8A-70	68	20	9100	SXD-14A-80	68	25	15020	SXD-32A-115	96	30	44000
SXD-2A-41	38	14	2302	SXD-4A-65	61	16	5654	SXD-8A-75	68	20	9100	SXD-14A-85	76	28	18244	SXD-32A-117	96	30	44000
SXD-2A-46	38	14	2302	SXD-4A-70	61	16	5654	SXD-8A-80	68	20	9100	SXD-14A-90	76	28	18244	SXD-32A-120	96	30	44000
SXD-2A-50	46	16	2302	SXD-4A-75	61	16	5654	SXD-8A-85	78	22	11063	SXD-14A-95	76	30	18244	SXD-32A-125	128	30	44000
SXD-2A-55	46	16	2302	SXD-4A-80	61	16	5654	SXD-8A-90	78	22	11063	SXD-14A-100	76	30	18244	SXD-32A-130	128	30	44000
SXD-2A-60	46	16	2302	-	-	-	-	SXD-8A-95	78	22	11063	SXD-14A-105	87	30	18244	SXD-32A-135	128	30	44000
-	-	-	-	-	-	-	-	SXD-8A-100	78	22	11063	SXD-14A-110	87	30	18244	SXD-32A-140	128	30	44000
-	-	-	-	-	-	-	-	SXD-8A-105	78	22	11063	SXD-14A-115	87	30	18244	SXD-32A-145	128	30	44000
-	-	-	-	-	-	-	-	-	-	-	-	SXD-14A-117	87	30	18244	SXD-32A-150	128	30	44000
-	-	-	-	-	-	-	-	-	-	-	-	-	-	-	-	SXD-32A-155	128	30	44000
-	-	-	-	-	-	-	-	-	-	-	-	-	-	-	-	SXD-32A-160	128	30	44000
-	-	-	-	-	-	-	-	-	-	-	-	-	-	-	-	SXD-32A-165	128	30	44000
-	-	-	-	-	-	-	-	-	-	-	-	-	-	-	-	SXD-32A-170	128	30	44000
-	-	-	-	-	-	-	-	-	-	-	-	-	-	-	-	SXD-32A-175	128	30	44000

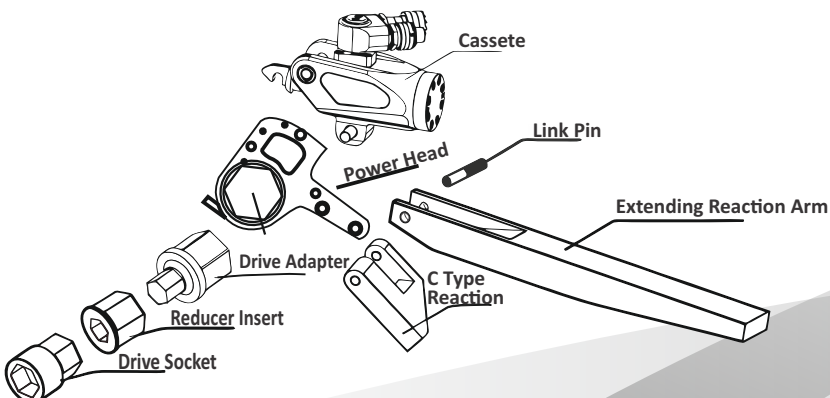

### ACCESSORIES

C Type Reaction	
Extending Reaction Arm	

**SOSD SPANNER SERIES****BENEFITS:**

- ★ Unique uni-swivel design at 360° X 185°
- ★ All alloy steel construction
- ★ Quickly interchangeable
- ★ Suitable for limited clearance applications such as valves, BOP, Xmas trees etc.

**DRIVE CYLINDER****G 360°x 185°****HEXAGON CASSETTE****CARTRIDGE****OPEN SPANNER****RATCHET CASSETTE****CLOSED SPANNER****SELECTION CHART**

Model	Torque (N.M)	Nut Sizes (MM)	Power Head Weight (KG)	Work Head Weight (KG)
SOSD-2	230 - 2302	19 - 60	1	1.53
SOSD-4	417 - 4170	34 - 80	2.3	4.53
SOSD-8	1100 - 11100	41 - 105	4.1	7
SOSD-14	1824 - 18243	50 - 117	7.05	12.6
SOSD-32	4400 - 44000	110 - 175	14.03	22.51

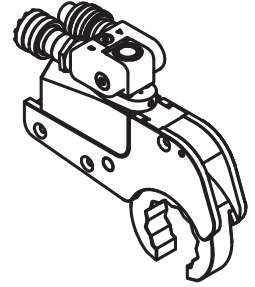
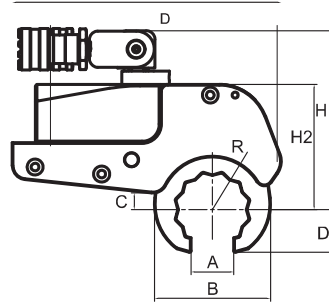
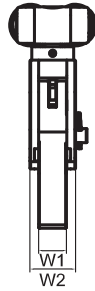

### SELECTION CHART

#### IMPERIAL

Model	Nut Size	SOSD-2 Open Spanner								
		Dimension (Inch)								
		A	B	C	D	R	H2	H1	W1	W2
SOSD-2-1.1/16	1.1/16"	0.79	1.83	0.49	0.51	1.46	3.46	4.46	0.77	1.26
SOSD-2-1.1/4	1.1/4"	0.87	2.36	0.49	0.67	1.46	3.46	4.46	0.77	1.26
SOSD-2-1.7/16	1.7/16"	1.00	2.66	0.49	0.79	1.46	3.46	4.46	0.77	1.26
SOSD-2-1.5/8	1.5/8"	1.10	3.05	0.49	0.95	1.46	3.46	4.46	0.77	1.26
SOSD-2-1.13/16	1.13/16"	1.22	3.27	0.49	1.06	1.46	3.46	4.46	0.77	1.26
SOSD-2-2	2"	1.34	3.46	0.49	1.22	1.46	3.46	4.46	0.77	1.26
SOSD-2-2.3/16	2.3/16"	1.44	3.68	0.49	1.34	1.46	3.46	4.46	0.77	1.26

Model	Nut Size	SOSD-4 Open Spanner								
		Dimension (Inch)								
		A	B	C	D	R	H2	H1	W1	W2
SOSD-4-1.5/8	1.5/8"	1.10	2.95	0.91	1.04	2.05	4.8	6.77	1.02	1.70
SOSD-4-1.13/16	1.13/16"	1.22	3.34	0.91	1.14	2.05	4.8	6.77	1.02	1.70
SOSD-4-2	2"	1.34	3.55	0.91	1.24	2.05	4.8	6.77	1.02	1.70
SOSD-4-2.3/16	2.3/16"	1.44	3.90	0.91	1.33	2.05	4.8	6.77	1.02	1.70
SOSD-4-2.3/8	2.3/8"	1.62	4.26	0.91	1.45	2.05	4.8	6.77	1.02	1.70
SOSD-4-2.9/13	2.9/16"	1.69	4.61	0.91	1.54	2.05	4.8	6.77	1.02	1.70
SOSD-4-2.3/4	2.3/4"	1.82	4.83	0.91	1.66	2.05	4.8	6.77	1.02	1.70
SOSD-4-2.15/16	2.15/16"	1.95	5.06	0.91	1.78	2.05	4.8	6.77	1.02	1.70

Model	Nut Size	SOSD-8 Open Spanner								
		Dimension (Inch)								
		A	B	C	D	R	H2	H1	W1	W2
SOSD-8-2	2"	1.34	3.41	0.94	1.16	2.64	5.77	7.74	1.30	2.09
SOSD-8-2.3/16	2.3/16"	1.44	3.74	0.94	1.27	2.64	5.77	7.74	1.30	2.09
SOSD-8-2.3/8	2.9/8"	1.62	4.09	0.94	1.39	2.64	5.77	7.74	1.30	2.09
SOSD-8-2.9/16	2.9/16"	1.69	4.51	0.94	1.54	2.64	5.77	7.74	1.30	2.09
SOSD-8-2.3/4	2.3/4"	1.82	4.85	0.94	1.68	2.64	5.77	7.74	1.30	2.09
SOSD-8-2.15/16	2.15/16"	1.95	5.28	0.94	1.75	2.64	5.77	7.74	1.30	2.09
SOSD-8-3.1/8	3.1/8"	2.08	5.61	0.94	1.87	2.64	5.77	7.74	1.30	2.09
SOSD-8-3.5/16	3.5/16"	2.23	5.84	0.94	2.05	2.64	5.77	7.74	1.30	2.09
SOSD-8-3.1/2	3.1/2"	2.39	6.07	0.94	2.13	2.64	5.77	7.74	1.30	2.09

Model	Nut Size	SOSD-14 Open Spanner								
		Dimension (Inch)								
		A	B	C	D	R	H2	H1	W1	W2
SOSD-14-2.3/4	2.3/4"	1.82	4.72	1.10	1.66	3.15	6.92	8.89	1.53	2.52
SOSD-14-2.15/16	2.15/16"	1.95	5.14	1.10	1.77	3.15	6.92	8.89	1.53	2.52
SOSD-14-3.1/8	3.1/8"	2.08	5.51	1.10	1.89	3.15	6.92	8.89	1.53	2.52
SOSD-14-3.5/16	3.5/16"	2.23	5.99	1.10	2.00	3.15	6.92	8.89	1.53	2.52
SOSD-14-3.1/2	3.1/2"	2.38	6.39	1.10	2.14	3.15	6.92	8.89	1.53	2.52
SOSD-14-3.11/16	3.11/16"	2.54	6.61	1.10	2.23	3.15	6.92	8.89	1.53	2.52
SOSD-14-3.7/8	3.7/8"	2.7	6.83	1.10	2.37	3.15	6.92	8.89	1.53	2.52
SOSD-14-4.1/4	4.1/4"	2.86	7.06	1.10	2.49	3.15	6.92	8.89	1.53	2.52
SOSD-14-4.3/8	4.3/8"	3.01	7.29	1.10	2.60	3.15	6.92	8.89	1.53	2.52

Model	Nut Size	SOSD-32 Open Spanner								
		Dimension (Inch)								
		A	B	C	D	R	H2	H1	W1	W2
SOSD-32-3.1/2	3.1/2"	2.38	6.20	1.22	2.15	4.33	8.99	10.95	1.98	3.35
SOSD-32-3.7/8	3.7/8"	2.69	6.65	1.22	2.39	4.33	8.99	10.95	1.98	3.35
SOSD-32-4.3/8	4.3/8"	3.01	7.46	1.22	2.62	4.33	8.99	10.95	1.98	3.35
SOSD-32-4.5/8	4.5/8"	3.27	8.22	1.22	2.78	4.33	8.99	10.95	1.98	3.35
SOSD-32-5.1/8	5.1/8"	3.37	9.06	1.22	3.07	4.33	8.99	10.95	1.98	3.35
SOSD-32-5.3/8	5.3/8"	3.57	9.29	1.22	3.19	4.33	8.99	10.95	1.98	3.35
SOSD-32-5.3/4	5.3/4"	3.98	9.74	1.22	3.42	4.33	8.99	10.95	1.98	3.35

#### METRIC

Model	Nut Size	SOSD-2 Open Spanner								
		Dimension (Inch)								
		A	B	C	D	R	H2	H1	W1	W2
SOSD-2-27	27	20	46	12	13	37	88	125	20	189
SOSD-2-32	32	22	60	12	17	37	88	125	20	189
SOSD-2-36	36	25	68	12	20	37	88	125	20	189
SOSD-2-41	41	28	77	12	24	37	88	125	20	189
SOSD-2-46	46	31	83	12	27	37	88	125	20	189
SOSD-2-50	50	34	88	12	31	37	88	125	20	189
SOSD-2-55	55	37	93	12	34	37	88	125	20	189

Model	Nut Size	SOSD-4 Open Spanner								
		Dimension (Inch)								
		A	B	C	D	R	H2	H1	W1	W2
SOSD-4-41	41	28	75	23	26	52	122	172	26	248
SOSD-4-46	46	31	85	23	29	52	122	172	26	248
SOSD-4-50	50	34	90	23	32	52	122	172	26	248
SOSD-4-55	55	37	99	23	34	52	122	172	26	248
SOSD-4-60	60	41	108	23	37	52	122	172	26	248
SOSD-4-65	65	43	117	23	39	52	122	172	26	248
SOSD-4-70	70	46	123	23	42	52	122	172	26	248
SOSD-4-75	75	50	128	23	45	52	122	172	26	248

Model	Nut Size	SOSD-8 Open Spanner								
		Dimension (Inch)								
		A	B	C	D	R	H2	H1	W1	W2
SOSD-8-50	50	34	87	24	28	67	147	197	53	298
SOSD-8-55	55	37	95	24	28	67	147	197	53	298
SOSD-8-60	60	41	104	24	28	67	147	197	53	298
SOSD-8-65	65	43	114	24	28	67	147	197	53	298
SOSD-8-70	70	46	123	24	28	67	147	197	53	298
SOSD-8-75	75	50	134	24	28	67	147	197	53	298
SOSD-8-80	80	53	142	24	28	67	147	197	53	298
SOSD-8-85	85	57	148	24	28	67	147	197	53	298
SOSD-8-90	90	61	154	24	28	67	147	197	53	298

Model	Nut Size	SOSD-14 Open Spanner								
		Dimension (Inch)								
		A	B	C	D	R	H2	H1	W1	W2
SOSD-14-70	70	46	120	28	42	80	176	39	64	369
SOSD-14-75	75	50	130	28	45	80	176	39	64	369
SOSD-14-80	80	53	140	28	48	80	176	39	64	369
SOSD-14-85	85	57	152	28	51	80	176	39	64	369
SOSD-14-90	90	61	162	28	54	80	176	39	64	369
SOSD-14-95	95	65	168	28	57	80	176	39	64	369
SOSD-14-100	100	69	173	28	60	80	176	39	64	369
SOSD-14-105	105	73	179	28	63	80	176	39	64	369
SOSD-14-110	110	77	185	28	66	80	176	39	64	369

Model	SOSD-32 Open Spanner										
	Nut Size	Dimension (Inch)									
		A	B	C	D	R	H2	H1	W1	W2	L
SOSD-32-90	90	61	158	31	55	110	228	278	50	85	425
SOSD-32-100	100	69	169	31	61	110	228	278	50	85	425
SOSD-32-110	110	77	190	31	67	110	228	278	50	85	425
SOSD-32-115	115	83	209	31	71	110	228	278	50	85	425
SOSD-32-130	130	86	230	31	78	110	228	278	50	85	425
SOSD-32-135	135	91	236	31	81	110	228	278	50	85	425
SOSD-32-145	145	101	247	31	87	110	228	278	50	85	425

## ELECTRIC DRIVEN TORQUE WRENCH PUMPS

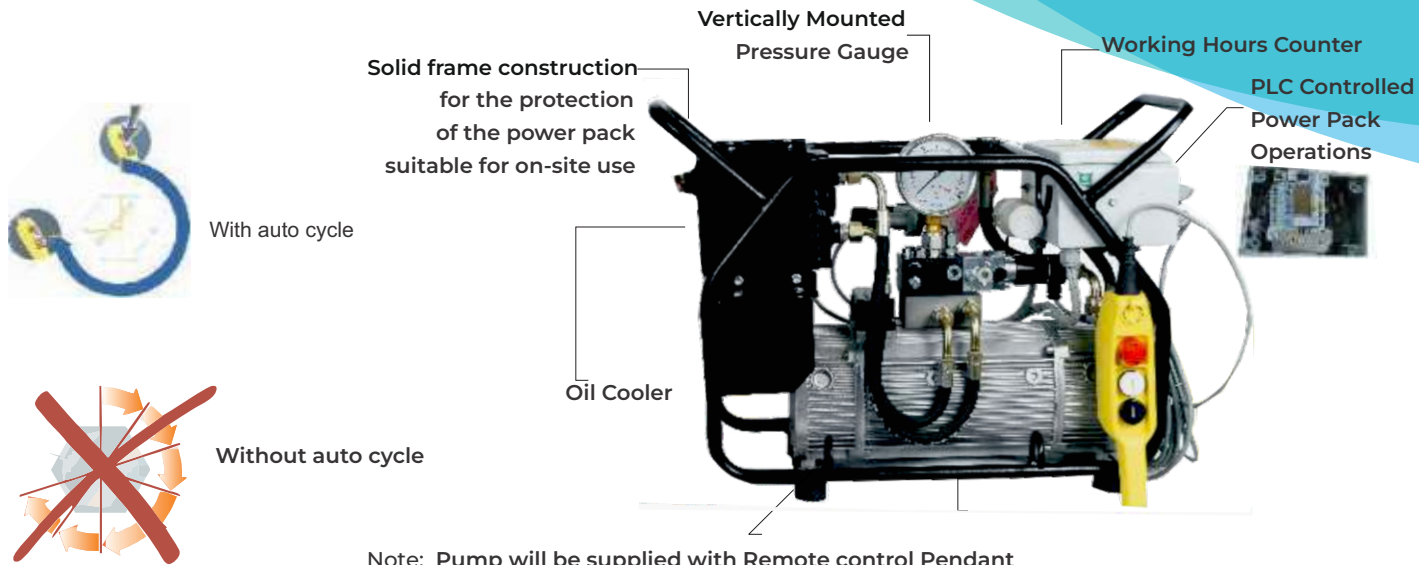

Note: Pump will be supplied with Remote control Pendant

## TECHNICAL SPECIFICATION:

Model No.	: SHPE1000
Power Rating	: 1.5 SP
Maximum Pressure	: 800 Bar
Flow Rate	: 9.7LPM@100Bar 0.97LPM@800Bar
Capacity	: 8Lt.

TYPE	SHPE-1000	SHPE-4000
Working	70 MPa	70 MPa
Drive	Electric	Electric
Voltage	220 V/50Hz	220 V/50Hz
Power	1.1 kW	1.1 kW
Tank Capacity	5.5L	5.5L
Flow Rate	7-1.6-0.8 L/min	7-1.6-0.8 L/min
Oil Cooler	Yes	Yes
Weight	25kg	27kg
Oil Outputs	2x1/4"NPT	4x1/4"NPT
LxWxH(mm)	445x304x304x426	461x304x426

## ADVANTAGES OF FULLY AUTOMATIC POWER PACKS

- FULLY AUTOMATIC POWER PACK**
  - Faster and reliable in operations
  - High repeatability of the bolting process without pressing the button again and again.
- TEMPERATURE MANAGEMENT**
  - The built heat exchanger to cool the system
  - The unique concept of the high-speed cooling and heat exchanger optimizes cooling for continuous operation.
  - Power pack switches off automatically if temperature rises above 800 C.
- OIL IMMERSER MOTOR**
  - Noiseless and vibration free operations
  - Efficient temperature equalization cooling motor, Pump & Oil at the same time
- PLC CONTROLLED SYSTEM**
  - Electrically controlled operation of power packs
  - If the power pack operates continuously more than 3 minutes idle, it gets switched off automatically.

## HIGH PRESSURE HOSE

- High quality hydraulic torque wrench bonded twin hose sets
- Maximum working pressure of 700 bar with 4:1 safety factor
- Ergonomically designed protective, strain reliever hand grips on both ends





### TECHNICAL SPECIFICATION :

Working Pressure 700 bar  
High Flow 3-Stage pump unit  
Compact and Lightwieghe

### FEATURES

- The Single valve block can be replaced by component FP-4, thereby allowing 2 or 4 tools to be driven simultaneously.
- Three stage with air drive.
- Supporting continuous operation with steel frame.
- 100mm diameter gauge, aluminum oil tank with oil level indicator.
- Variable pressure adjustment between 1000~10000 psi
- Designed for continuous operation.
- Supplied with 5 mtr twin hoses and quick connect couplings suitable for SXD and SSD torque wrenches.
- 



### SELECTION CHART

TYPE	SHPA-2	SHPA-4
Working Pressure	70 MPa	70 MPa
Drive	Air	Air
Air Pressure	≥3.4 m³/min	≥3.4 m³/min
Power	4.0HP	4.0HP
Tank	5.5L	5.5L
Flow Rate	10-2-21.1 L/min	10-2-21.1 L/min
Oil Cooler	Yes	Yes
Weight	19kg	21kg
Pill Outputs	2x1/4"NPT	4x1/4"NPT
Air in	4~8 bar	4 ~8 bar
LxWxH (mm)	442x282x377	460x282x377

# Hydraulic Bolt Tensioner

**BHARTIYA**

TUBE TOOLS



### FEATURES :

- Shingare hydraulic bolt tensioners have eight load cells from M16 to M150 or from 5/8" to 5 3/4".
- Twin ports for quick connection of multiple tools.
- Only one size of bridge as per size of load cell.
- Detachable and rotational bridge simplifies bolt tensioner positioning.
- Full bridge window.
- Black surface treatment protects against corrosion.
- Anti-slip grip for more secure handling.
- Universal and multi-use tool.
- Double Straight Reaction Arm.
- Blank Reaction Arm.



### Why Tensioning ?

Safe, reliable and repeatable, the use of hydraulic tensioners has many advantages over other less accurate tightening methods.

- Tension is applied directly to stretch the bolt, so we don't need to fight against friction or losses.
- The applied load is controlled very accurately, because it is directly proportionate the pressure applied to the tensioner.
- The load transfer factor is calculable, helping to give the correct residual load.
- Operation of Tooling and improved accuracy reduces time required to re-tension the load.
- Tensioning allows for loading multiple fasteners in a joint at the same time.
- Uniform bolt loading ensures a high level of accuracy by applying a constant force.
- Purely axial, tensile loading ensures no torsional stresses are introduced.

### SBT SERIES SELECTION CHART

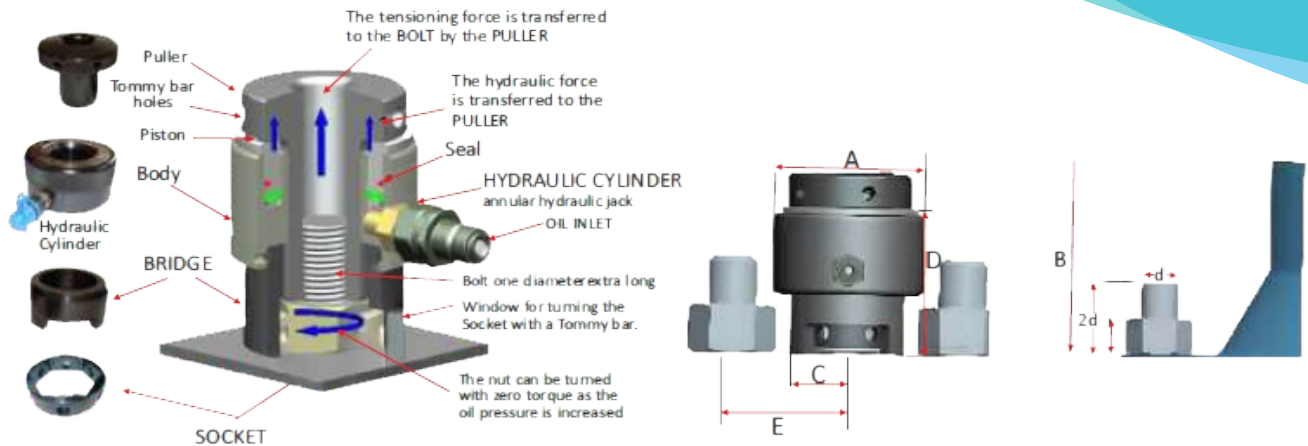

Model	Bolt Size		Cylinder	Area	Dimension					Weight
	Metric	Inch			A	B	C	D	E	
SBT-3	M16 M18 M20 M22 M24	- 3/4" - 7/8" 1	23.5	15.7	75	168	32.5	90	47-51	2
SBT-5	M27 M30 M33 M36 M39	1-1/8" - 1-1/4" 1-3/8" 1-1/2"	50	33	102	187	47	106	65-71	4
SBT-9	M39 M42 M45 M48	1-1/2" 1-5/8" 1-3/4" 1-7/8"	90	59.7	133	208	61	120	86-93	6
SBT-13	M52 M56 M60 M64	2" 2-1/4" - 2-1/2"	130	83	163	231	73	135	106-114	10
SBT-19	M64 M68 M72 M76	2-1/2" - 2-3/4" 3"	190	123	193	254	86.5	150	129-135	15
SBT-27	M76 M80 M85 M90 M95 M100	3" - 3-1/4" 3-1/2" 3-3/4" 4"	270	176	233	286	110	180	155-167	24
SBT-44	M110 M120 M125	4-1/2" 4-3/4" 5"	440	251	280	304-338	111-121	181-197	210-233	45
SBT-54	M130 M140 M150	5-1/4" 5-1/2" 5-3/4"	540	317	325	354-388	126-141	202-216	243-275	73

## SBTE SERIES MULTI-STAGE BOLT TENSIONER

### FEATURES AND BENEFITS

Multi- Cylinder Design, Increase the Tension Length.  
Strong capacity with small outside diameter,  
it is suit for the operation narrow space.

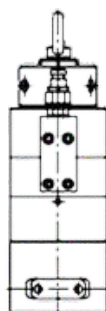
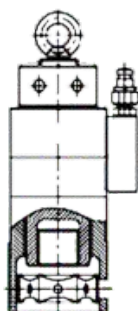

### SELECTION CHART

MODEL	SBTE-30	SBTE-36	SBTE-39	SBTE-42	SBTE-48
Maximum Operation Pessure	1350Bar	11350Bar	1350Bar	1350Bar	1250Bar
Maximum Output Capacity	465KN	678KN	915KN	915KN	1202KN
Maximum Stroke	7mm	10mm	10mm	10mm	10mm
Cylinder Effect Area	3448mm <sup>2</sup>	5027mm <sup>2</sup>	6830mm <sup>2</sup>	6830mm <sup>2</sup>	9621mm <sup>2</sup>
Quantity of Cylinder Step	2	2	2	2	2
Outside Diameter	72mm	84.5mm	98.5mm	98.5mm	129mm
Bolt Size	M30×3.5	M36×4	M39×4	M42×4.5	M42×4.5

Description	Metric (mm)	Imperial (Inches)
A - Nut Across Flat		
B - Back Wall Distance From Stud / Bolt Center		
C - Center to Center Distance of Stud / Bolt		
D - Diameter of Stud / Bolt		
E - Nut to Nut Edge Distance		
G - Residual Stud / Bolt Load		
H - Height of Nut		
J - Pitch Circle Diameter		
K - Flange Outside Diameter		
L - Protruded Thread Length of Stud / Bolt		
M- Washer Outside Diameter		
N - Washer Thickness		
P - Distance		
Q- Distance if Applicable		
R - Number of Studs		
S - Hex Nut of Round Nut, if Round Nut - Mention OD		

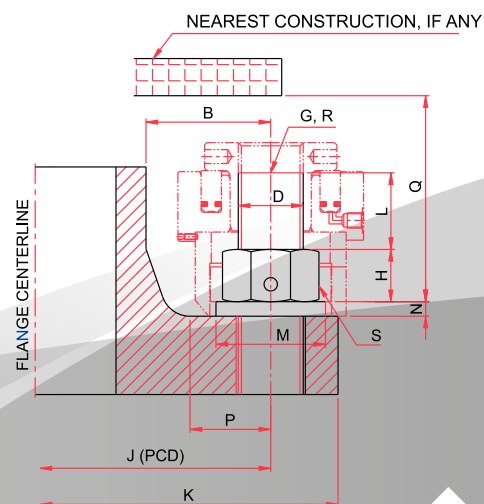
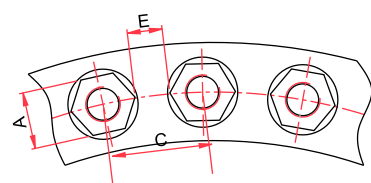



## HIGH PRESSURE HAND PUMP

### SHP MANUAL PUMPS

Manual Pumps with twin stage cylinders, for both single and double acting jacking cylinders and an automatic spill free venting valve to increase pumping efficiency on non Marine specification models.



### MATERIAL

- Cast and Drawn Aluminum Body.
- Thermoplastic Hose with Spiral Steel Reinforcement
- ISO14540 Steel Coupling.
- Pressure Gauge 180 MPA with Protective Cover.

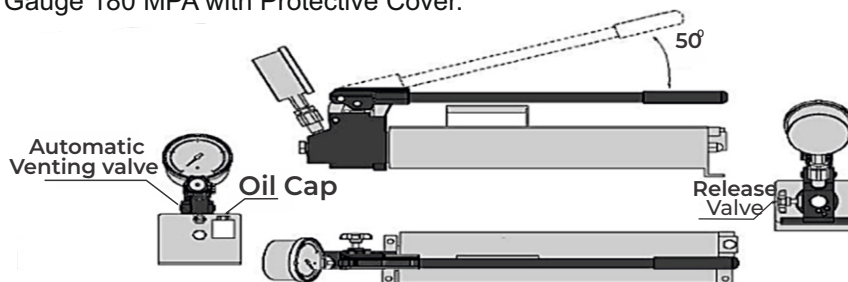

### SERIES SHP MANUL PUMPS

Category  
Hand Pump

Description Class  
Twin stage, 180 Mpa

Max working pressure  
180.0 Mpa

Pressure Gauges  
Gauge included

Tank Volume (l)  
2.2

Description  
Marine engine maintenance specification, for use with single acting cylins.

## ELECTRIC DRIVEN TENSIONER PUMP (SETP)

### FEATURES OF POWER PACK:

- Brand new technology: Combine unit of Low pressure and high pressure equipments.
- Less High pressure components used, hence maintenance cost is less.
- All components are Highly precise and reputed make.
- Substantial savings in energy and oil consumption.
- Analog or Digital pressure gauges assure the highest possible read out and adjustment precision.
- High speed/flow.
- Remotely operation orward and reverse.
- Light weight & compact design.



### OPTIONAL ACCESSORIES:

- High pressure hose
- High pressure QRC (Quick Release Coupling)
- Digital Pressure Gauge

### SELECTION CHART

Tensioning Pump - Model SETP-1500 (Tensioning Pump)		
<b>Pump</b>		
Main Voltage	AC	230 V, 50Hz
Solenoid Voltage	AC	230 V
Main Consumption	A	10
Motor Capacity	kW	1.5
Protected According to	IP	IP 55
Nominal Pressure	bar	0-1500
<b>Flow</b>		
Flow @ 1500 Bar	lpm	0.1 @ 1500 bar
Tank Volume	litre	14
Oil Type		Servo 68
Ambient Temperature	C	45°
Max Oil Temperature	C	60°
<b>Weight</b>		
Weight without oil	Kg	35 Approx

## AIR OPERATED TENSIONER PUMP (SATP)

The air operated powerpack for bolt tensioner SATP-1500 are designed to meet the highest technical and safety requirements of high pressure equipment.



### TECHNICAL FEATURES

- **Stainless Steel Frame:** The hydraulic unit is installed in a weather proof stainless steel protection frame.
- **Logical Control Panel:** Logical layout design engraved for easy operation.
- **Calibrated Pressure Gauge:** Calibrated 150mm (6"), liquid filled, SS Frame, 2500 bar rating pressure gauge with dual reading of bar & psi.
- **Complete Air System:** System includes FRL Unit, air pressure gauge and control knob for safe air control and supply.
- **Higher Operating Pressure:** Pump has max working pressure of 1500 bar to cover all bolt tensioning applications.
- **Light Weight:** Unit weighs only 18 Kg and measures 450mm x 340mm x 480mm.
- **Lower Input air Pressure:** Higher pressure ratio of 1350 ensures less input air pressure for operation.
- **Quick Connect Outlet:** Pump comes fitted with quick connect outlet for easy connection of hydraulic hose.

### OPTIONAL ACCESSORIES:

- High pressure hose.
- High pressure QRC (Quick Release Coupling)
- Digital Pressure Gauge.

## SELECTION CHART

Technical Details - Model SATP-1500 (Bhartia Air Operated Tensioner Pump)		
Pump		
Pressure Ratio		1:350
Displacement Volume	cm <sup>3</sup>	1.3
Operating Pressure, Max. ( at 5.1 bar Pre Limited (PL) Air Pressure)	bar	1800
Compressed air supply (air drive)		
System Operating Air Pressure, Max.	bar	5.1
Safety Valve Set Pressure	bar	5.5
Stainless Steel Tank Capacity		
Oil Tank capacity	litre	5

# High Pressure Hydrotest Pump



## KEY FEATURES

- Infinitely variable output pressure and fluid displacement speed.
- Integral inlet air filtration and lubrication unit with air pressure gauge.
- Air line regulator for easy setting of input air and output hydraulic pressure.
- Maximum air consumption of 0.79 m<sup>3</sup> (28 scfm) per minute at 7 bars.
- Smooth and easily operated hydraulic pressure hold and release valve.
- Fitted with input air pump start/stop valve for easy and fast pressure shut off.
- Robust stainless-steel protective framework.
- Lightweight plastic, 7.5 litres capacity, fluid reservoir.
- Optional stainless-steel reservoir, stroke counter system and pressure is also available on request.
- No Airline Lubricator required.
- Wide range of models with different ratios.
- Easy to install, operate and maintain.
- Heat, Flame, spark and Explosion proof.
- Automatic Pressure holding.

## SELECTION CHART

Model	Pressure Ratio	Inlet Air Pressure	MAX Outlet Pressure(bar)*	Air Inlet Port	Outlet Port	Max Flow (L/min)**
SHP/32	4:1	3-8 bar	32	G 1/2	NPT	70.0
SHP/48	6:1	3-8 bar	48	G 1/2	NPT	29.91
SHP/80	10:1	3-8 bar	80	G 1/2	NPT	18.84
SHP/128	16:1	3-8 bar	128	G 1/2	NPT	12.42
SHP/224	28:1	3-8 bar	224	G 1/2	NPT	7.11
SHP/320	40:1	3-8 bar	320	G 1/2	NPT	4.89
SHP/512	64:1	3-8 bar	512	G 1/2	NPT	3.08
SHP/640	80:1	3-8 bar	640	G 1/2	NPT	2.44
SHP/800	100:1	3-8 bar	800	G 1/2	NPT	1.92
SHP/1040	130:1	3-8 bar	1040	G 1/2	NPT	1.47
SHP/1400	175:1	3-8 bar	1400	G 1/2	NPT	1.14
SHP/2040	255:1	3-8 bar	2040	G 1/2	NPT	0.75
SHP/3200	400:1	3-8 bar	3200	G 1/2	NPT	0.48
SHP/4080	510:1	3-8 bar	4080	G 1/2	NPT	0.65
SHP/6400	800:1	3-8 bar	6400	G 1/2	NPT	0.42



## APPLICATIONS



- Pressure Testing
- Hydraulic Testing
- Liquefied Gas Transfer
- Precision Lubrication and Spraying
- Roller Tensioning
- Metering
- Work Holding / Power Clamping

## CIRCULAR CHART RECORDER (P-T)

### FEATURES:

- Mercury Free or Mercury Filled Temperature Systems Available.
- All – Welded construction prevents deterioration.
- Carefully heat-treated coil provides superior spring action.
- Durable, low maintenance design: thermal system and other parts easily replaced by field technician.
- 300 Series stainless steel bulb, interconnection apillary, and armour available on certain designs.
- Standard case compensated system for uncompensated capillary lengths not exceeding 25'
- ALL 316 Stainless Steel Pressure Elements.

Weather proof construction, heavy die cast aluminum case with white powder coat finish, heavy lockable door with weather stripping, available with or without window, ruggedly built for outdoor use and to withstand high levels of vibration, ½" diameter screened air vent holes, adjustable drawer pull latch with available Safety lock, all stainless steel corrosion resistant internals, felt tippens, micro-adjustable wire linkage, 8" and 12" circular chart sizes one, two, or three felt tippens option for a combination of both pressure and temperature.



# Pneumatic Torque Wrench

**BHARTIYA**

TUBE TOOLS



### OPERATING THE WRENCH

- Fit the wrench with the correct size impact socket to suit the bolt to be tightened.
- Check that the Forward/Reverse switch is set correctly.
- Rotate the handle to a convenient position relative to the Reaction Arm.
- Fit the tool onto the bolt to be tightened with the Reaction Arm adjacent to the reaction point.
- Squeeze the Trigger (F) partially to bring the Reaction Arm into contact with the reaction point.
- When the tool is in operation the Reaction Arm rotates in the opposite direction to the Output Square Drive and must be allowed to rest squarely against a solid object or surface adjacent to the bolt to be tightened.
- Trigger keeps fully depressed until wrench stalls. If the Trigger is released before the wrench stalls, full torque will not be applied to the bolt.
- Release Trigger and remove the tool from bolt.

### ASSEMBLY

- Blow out hoses before connecting.
- Connect the wrench Air Inlet- to the outlet side of the cage Assembly, observing airflow direction.
- Connect air supply to inlet side of the cage Assembly using a minimum hose size of 1/2"
- Check oil level in lubricator and fill to correct level.
- Attach Reaction Arm (B) to Spline or Serpentine (C) adjacent to the Output Drive (D) of the wrench and secure with circlip.

### SAFETY

- ALWAYS wear safety goggles when the tool is in operation.
- Make sure the reaction arm is in contact with a solid contact point before you operate the tool.
- Keep your body Parts clear of the reaction arm and the contact point.
- Set your air pressure while the tool is running.
- Refer to the enclosed torque chart to set the correct air pressure regulator setting for a required torque.
- NEVER exceed the maximum air pressure shown on the torque chart.

### SELECTION CHART

Model No.	Min. Torque		Max. Torque		Free Speed	Square Drive	Weight	
	Ft /Lbs	Nm	Ft /Lbs	Nm	RPM	INCH	Kg.	Lbs
SPTW-13	30	45	130	180	42	1/2" / 3/4"	6.0	13.2
SPTW-50	125	170	500	680	25	1/2" / 3/4"	7.0	15.5
SPTW-75	185	250	750	1020	15	3/4" / 1"	7.0	15.5
SPTW-100	250	340	1040	1400	9	3/4" / 1"	7.0	15.5
SPTW-220	560	750	2200	3000	6	1" / 1.1/2"	10.0	22
SPTW-300	750	1010	3000	4050	3	1" / 1.1/2"	11.0	24.3
SPTW-400	1000	1350	4000	5400	2.5	1.1 / 2"	13.60	30
SPTW-480	1200	1650	4800	6500	2	1.1 / 2"	13.60	30
SPTW-600	1630	2200	6000	8100	1.5	1.1 / 2"	13.60	30

### IMPORTANT:

**DO NOT OPERATE THE TOOL BEFORE READING THESE INSTRUCTIONS, IF BREAKDOWN, MALFUNCTION OR DAMAGE OCCURS, DO NOT ATTEMPT TO REPAIR, PLEASE CONTACT US IMMEDIATELY**

#### 1/2" NPT INLET

Install your air supply to the 1/2" NPT female part in the regulator. A minimum 1/2" air line must be used capable of 100 psi at 50 cfm.



**NOTE: Air supply must be a minimum of 90 psi@ 50 cfm**

#### 1/2" NPT INLET

Install the supplied airline to the 1/2" NPT outlet part on the automatic oiler. The quick connect fitting at the opposite end of the hose will be attached to tool.

#### AUTOMATIC OILER

Fill the automatic oiler with air tool oil only. Fill from the top or by removing and filling the bowl, then reinstalling from the bottom.

Pneumatic Torque Wrenches are reversible, non-impact, torque controlled tightening tools and must always be operated with the following:

- Clean dry air supply with a minimum flow of 100psi and 30cfm and 1/2" air line
- Cage Assembly with lubricator and regulator
- Impact Sockets
- Proper Reaction Arm
- To increase air pressure (and torque) turn the "T" handle (Air Pressure Regulator) clockwise
- Always set air pressure with tool running.

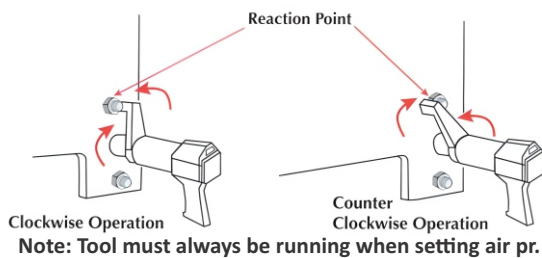

C (Spline or serpentine) E (Forward & Reverse switch)



D (Output Square Drive)

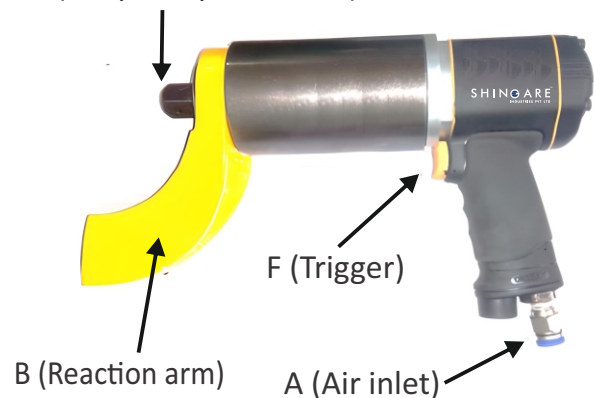

# Electric Torque Wrench





**EWS SERIES**

**EWS Electric** torque wrench is designed to install heavy hex structural bolts. It has square drive end so that same machine can be used for different hexagon nut by using suitable socket. It shuts off when the torque requirements is reached. The tools offers a non-reactive torque controlled option for hex bolt installation. This series of wrenches adopts German motors. Strong power, Durable and Stable performance are its famous features.

These tools are used for a variety of different tasks across many industries – including home repairs and maintenance, automotive and construction. It's important to always use this tool in applications where screws and bolts must be secure and tight. These tools allow the user to measure the amount of pressure being applied to fasteners, to ensure it matches the recommended specifications for the job.

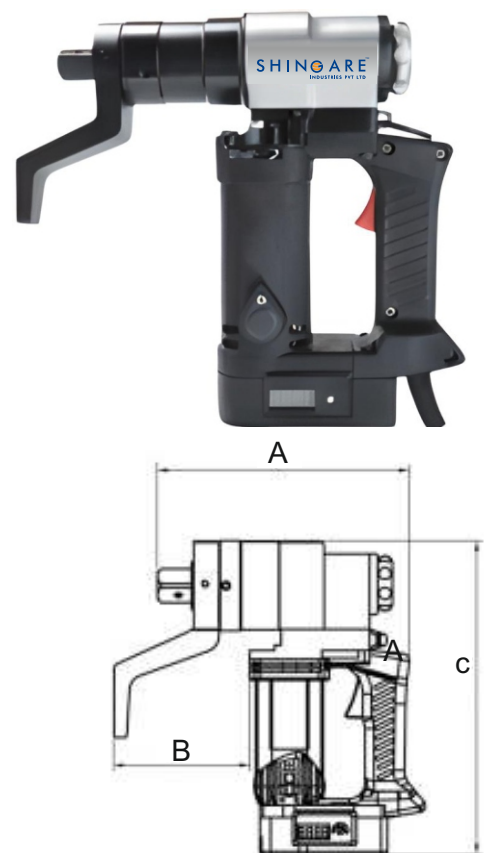
**Product Analysis****FEATURES:**

- Easy switch directions Applying reaction arm to closet object, Tighten up to target torque.
- Perfect solution for your work at narrow space.
- Ultra compact socket with an integrated reaction arm.
- Easily set your target torque with dial on the Controller.
- Versatile performance of our electric torque wrench for bridge construction, steel fabrication and any kind of heavy industry.
- Available with both direction forward and reverse.
- Shortest profile and compact socket make accessible to bolts at any narrow space.

Model No.	Torque (Nm)	Square Drive	Weight (Kg)	Speed (Rpm)
EWS-3	100-300	3/4"	4	24
EWS-5	200-500	3/4"	4.2	15.5
EWS-7	300-700	1"	4.6	15
EWS-9	400-900	1"	5.1	9.5
EWS-12	500-1200	1"	6.3	9
EWS-21	1000-2100	1.1/2"	7.2	6
EWS-25	1100-2500	1.1/2"	9	5
EWS-35	1700-3500	1.1/2"	15	2.5
EWS-60	3000-6000	1.1/2"	18	0.6
EWS-100	5000-10000	2.1/2"	21	0.3

### EWB SERIES

**EWB Series** Electric torque wrench is designed to install heavy hex structural bolts, non-impact, electricity. It has square drive end so that same machine can be used for different hexagon nut by using suitable socket. It shuts off when the torque requirements is reached. The tools offers a non-reactive torque controlled option for hex bolt installation. This series of wrenches adopts German motors. Strong power, Durable and Stable performance are its famous features.

These tools are used for a variety of different tasks across many industries – including home repairs and maintenance, automotive and construction. It's important to always use this tool in applications where screws and bolts must be secure and tight. These tools allow the user to measure the amount of pressure being applied to fasteners, to ensure it matches the recommended specifications for the job.

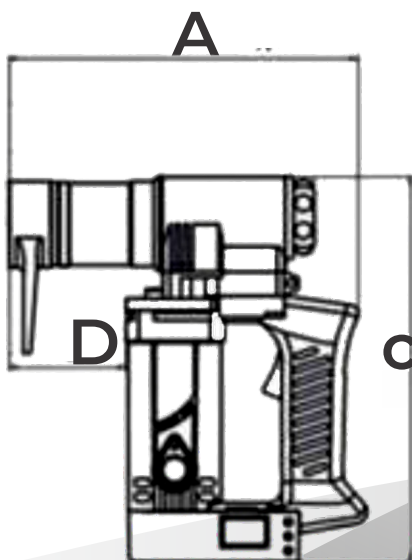

## Product Analysis



## FEATURES:

- Available with both direction forward and reverse.
- Shortest profile and compact socket make accessible to bolts at any narrow space.
- Easy switch directions Applying reaction arm to closet object, Tighten up to target torque.
- Perfect solution for your work at narrow space.
- Easily set your target torque with dial on the Controller.
- Versatile performance of our electric torque wrench for bridge construction, steel fabrication and any kind of heavy industry.
- Ultra compact socket with an integrated reaction arm.

## SELECTION CHART

Model No.	Torque (Nm)	Speed (Rpm)	Weight (Kg)	Direct Hex Available	Diameter D	Overwall Length A (mm)	Overwall Width C (mm)
EWB-3	100-300	28	4	M10,M12,M16	80	240	267
EWB-5	200-500	20	4.2	M12,M16,M20	111	271	267
EWB-7	300-700	18	4.6	M16,M20,M22	54	221	269
EWB-9	400-900	16	5.1	M20,M22,M24	71	238	275
EWB-12	500-1200	14	6.3	M22,M24,M27	50	225	287
EWB-21	1000-2100	10	7.2	M27,M30,M33	95	274	286
EWB-25	1100-2500	5	9	M30,M33,M36	107	283	293
EWB-35	1700-3500	4.5	15	M33,M36,M42	107	283	293

## ESL SERIES

To Install TC Bolts, you need a ESL series shear wrenches. This is an electric wrench with counter-rotating sockets. The proper gun for each diameter bolt should be determined. TC bolts are structural bolts used for steel structure construction. Therefore, these bolts are created to provide the highest... Moreover, though its fastening mechanism is complicated, TC bolts are easy to use and can be installed by just one person. The inbuilt functionalities of these bolts allow for determining the tensioning required to hold together a structure. With the help of this functionality, users can also figure out whether the required tension has been achieved, regardless of how much torque was applied to achieve the tension.



### Electric Shear Wrench Working Principle

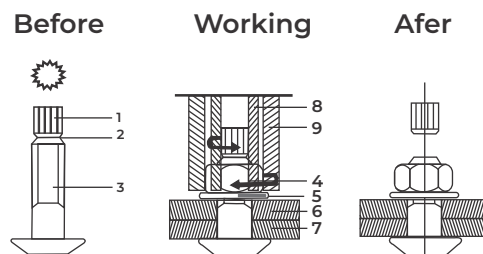

- |              |               |                |
|--------------|---------------|----------------|
| 1 Spline end | 4 Nut         | 4 Steel Plate  |
| 2 Groove     | 5 Washer      | 5 Outer Socket |
| 3 Thread     | 6 Steel Plate | 6 Inner Socket |

### FEATURES:

- All Shear Wrenches are calibrated and certified on in-house test bench in our facility.
- Hence, this wrench is very suitable for various complex construction environments.
- Bharitya ESL-Series light weight and compact shear wrenches provide consistent, reliable torque tightening and shearing to the tension control bolts.
- Bhartiya Electric Shear Wrenches are capable of achieving controllable torque range of 5000 Nm with supported bolt sizes till M36.
- Compared with general shear wrench, Electric Shear Wrench biggest feature is that the working head can rotate 360 degrees horizontally relative to the position of the handle.

### SELECTION CHART

Model No.	Torque (Nm)	Bolt Size (Nm)	Weight (Kg)	Speed (Rpm)
ESL-16	320	M12,M16	3.8	36
ESL-2	540	M12,M16,M20	6	24
ESL-22	910	M16,M20,M22	6.8	20
ESL-24	1200	M20,M22,M24	8	14
ESL-27	1700	M22,M24,M27	8.3	12
ESL-30	2500	M24,M27,M30	10.5	5
ESL-33	3500	M27,M30,M33	15	4.5
ESL-36	5000	M30,M33,M36	17	2.5

# HYDRAULIC TORQUE WRENCH

**BHARTIYA**

**TUBE TOOLS**

Bolt Size	A/F	Bolt Grade: 8.8				Bolt Grade: 10.9				Bolt Grade: 12.9				Bolt Size	A/F	Bolt Grade: B7/B16			
		Torque Values (Nm)			Tension (kN)	Torque Values (Nm)			Tension (kN)	Torque Values (Nm)			Tension (kN)			Torque Values (Nm)			Tension (kN)
		μ=0.10	μ=0.15	μ=0.2		μ=0.10	μ=0.15	μ=0.2		μ=0.10	μ=0.15	μ=0.2				μ=0.10	μ=0.15	μ=0.2	
M16	24	121	165	208	54	171	232	292	76	205	278	351	91	5/8"	1.1/16"	126	171	215	57
M18	27	165	224	283	66	233	316	399	92	279	379	478	111						
M20	30	237	322	406	85	333	452	571	119	400	543	685	143	3/4"	1.1/4"	226	306	387	85
M22	32	327	443	560	106	459	623	787	149	551	748	945	179	7/8"	1.7/16"	366	496	627	117
M24	36	409	556	702	122	576	781	987	171	691	938	1184	206	1"	1.5/8"	549	745	941	154
M27	41	608	828	1043	161	855	1161	1467	226	1027	1393	1760	272						
M30	46	820	1113	1406	195	1154	1566	1978	275	1384	1879	2373	330	1.1/8"	1.13/6"	816	1107	1398	204
M33	50	1128	1531	1933	244	1586	2152	2719	343	1903	2583	3263	412	1.1/4"	2"	1157	1570	1983	260
M36	55	1442	1957	2472	286	2028	2752	3476	402	2433	3302	4171	483	1.3/8"	2.3/16"	1582	2147	2712	324
M39	60	1881	2553	3225	345	2646	3590	4535	485	3175	4308	5442	581	1.1/2"	2.3/8"	2100	2850	3600	394
M42	65	2317	3145	2973	394	3259	4423	5587	554	3911	5307	6704	665	1.5/8"	2.9/16"	2720	3692	4663	471
M45	70	2912	3952	4992	462	4095	5558	7021	650	4914	6670	8425	780	1.3/4"	2.3/4"	3452	4685	5917	555
M48	75	3490	4737	5984	519	4909	6662	8415	730	5890	7994	10097	877	1.7/8"	2.15/16"	4304	5841	7378	645
M52	80	4545	6169	7792	624	6392	8675	10958	878	7670	10410	13149	1054	2"	3.1/8"	5285	7173	9060	743
M56	85	5642	7658	9673	720	7935	10768	13602	1012	9522	12922	16323	1214	2.1/4"	3.1/2"	7674	10414	13155	959
M60	90	7076	9603	12130	842	9951	13504	17058	1185	11941	16205	20470	1422						
M64	95	8535	11583	14631	953	12002	16289	20575	1340	14403	19547	24690	1607	2.1/2"	3.7/8"	10691	14509	18327	1203
M68	100	10405	14121	17838	1093	14632	19858	25084	1537	17559	23830	30101	1844	2.3/4"	4.1/4"	13038	17694	22350	1333
M72	105	12530	17005	21480	1243	17620	23913	30206	1748										
M76	110	14926	20256	25587	1403	20989	28485	35981	1973										
M80	115	17608	30185	1572	1572									3"	4.5/8"	17104	23213	29321	1603
M85	120	21390	29029	36668	1797														
M90	130	25676	34847	44017	2038									3.1/4"	5"	21938	29774	37609	1898
M95	135	30500	41393	52286	2293									3.1/2"	5.3/8"	27607	37467	47326	2218
M100	145	35893	48712	61531	2564									3.3/4"	5.3/4"	34176	46382	58588	2563
M105	150	41886	56846	71805	2849									4"	6.1/8"	41712	56610	71507	2933
M110	155	48511	65837	83162	3150														

$\mu=0.10$  - Lubricated Bolts

$\mu=0.15$  - Semi Lubricated Bolts

$\mu=0.2$  - Dry Bolts

Newton - Meter Nm to Foot-Pounds lbf. ft. (1Nm = 0.738 lbf. ft.)

Kilogram - Force Meter to Newton - Meter (1 Kgm = 9.80 Nm)



## SBTCX SERIES-BATTERY TORQUE WRENCH

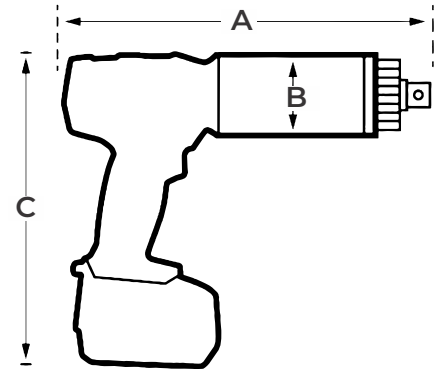

### FEATURES :

- Digital display
- Adjustable torque from 1N.m to 4000N.m
- Accuracy +/- 5% of reading
- Repeated Accuracy: ±2%

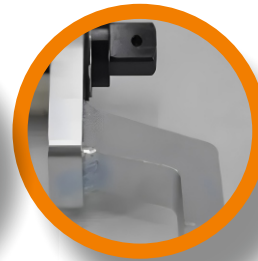

### SELECTION CHART

Model No.	SQ Drive	Torque (Nm)		Speed	Weight	Size A	Size B	Size C	Size D
		Min	Max	RPM	(Kg)	(mm)	(mm)	(mm)	(mm)
SBT07CX	3/4"	230	700	13	3.5	231	63	67	262
SBT07-2CX	3/4"	230	700	21.5	4.3	279	63	67	262
SBT14CX	3/4"	300	1400	10.5	3.5	231	63	67	262
SBT20CX	1"	400	2000	6	4.0	244	63	69	262
SBT40CX	1"	800	4000	3	6.0	285	69	81	266
SBT70CX	1.5"	1350	7000	1.6	8.8	295	95	95	272

### APPLICATION:



# Other Product Range :

**BHARTIYA**

TUBE TOOLS

## TUBE TOOLS



**TUBE CLEANING EQUIPMENTS**

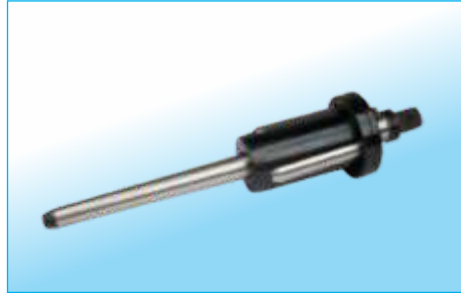

**TUBE EXPANDER**



**EXPANSION MACHINES**

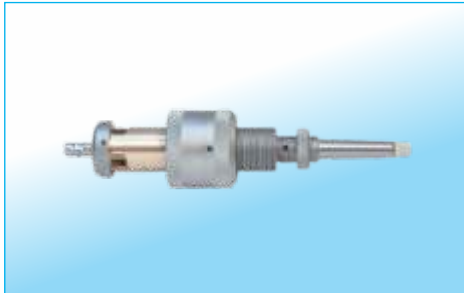

**TUBE INSTALLATION TOOLS**



**HYDRO JET CLEANING MACHINE**



## BEVELING MACHINE, BUNDLE PULLER, LINE BORING MACHINE



**PIPE BEVELING MACHINE**



**LINE BORING MACHINE**



**WATER JET CUTTING MACHINE**



**BUNDLE PULLER**



**PIPE CUTTING &  
BEVELING MACHINE**



**FLANGE FACING MACHINE**

# Proudly Associated With...



## SHINGARE INDUSTRIES PVT. LTD.

Formerly known as Bharatiya Industries

- ✿ Manufacturer & Exporter of Tube Cleaners, Flexible Shafts, Tube Tools, Impact Sockets, Bolting Tools, Pipe Cold Cutting and Beveling Machines, Torque Tools, Grinding Tools, Tapping Tools, Hydraulic Torque Wrench, Electric Torque Wrench, Manual Torque Wrench & Torque Multiplier
- 📍 **Works:** A-48 B Osiya Mataji Compound, Village Kalher, Retibunder Road, Tal. Bhiwandi, Dist. Thane - 421302, Maharashtra.
- 📍 **India Sales Off:** B-227, 2nd Floor, Eastern Business District (Neptune Magnet Mall), L.B.S. Marg, Bhandup (west), Mumbai - 400078.
- 🌐 [www.shingare.com](http://www.shingare.com) | [www.tubecleaner.co.in](http://www.tubecleaner.co.in)